



# COSMO+PLUS

# ARIEL

**J807**

**59"L x 30"W x 30"H**

APPROX. OPERATING GALLONS: 49

- Sleek, contemporary look
- High-gloss/high-impact, UV-resistant acrylic will not dull or fade
- Installation: Freestanding
- Leveling feet
- Integrated linear waste & overflow with white drain cap



COLORS AVAILABLE: White



accommodates  
stacked packaging

## ABOVE FLOOR DRAIN KIT

- Freestanding tub rough-in
  - Install before tile
  - Designed to be installed in a 8" to 10" joist space
  - Can be installed with waterproof membrane
- Sold separately. Not required for tub install.**



FOR INFORMATION OR  
TO PLACE AN ORDER  
**CALL 1.800.288.7771**

# ARIEL

**J807** SHIPPING WEIGHT: 108 lbs

**59"L x 30"W x 30"H**

**COSMO+PLUS**

TECHNICAL SPECIFICATIONS

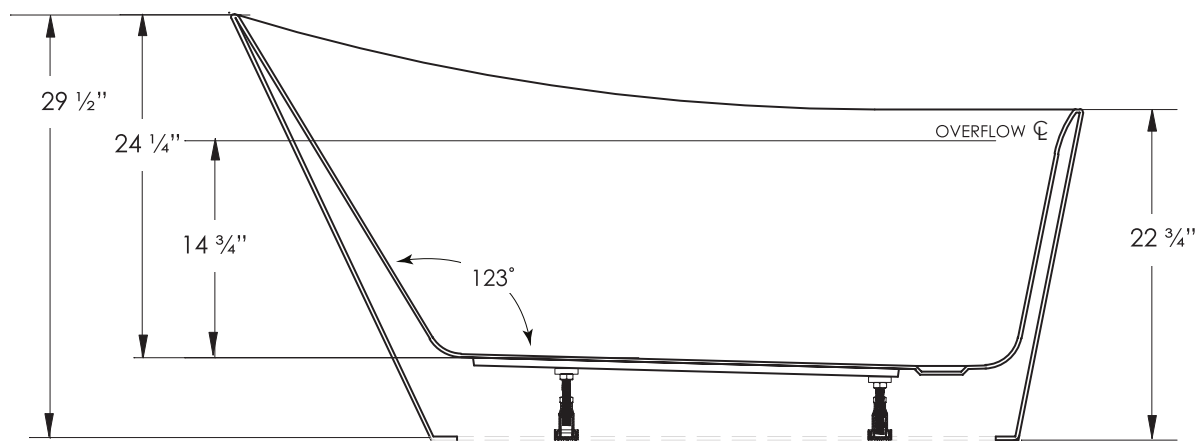
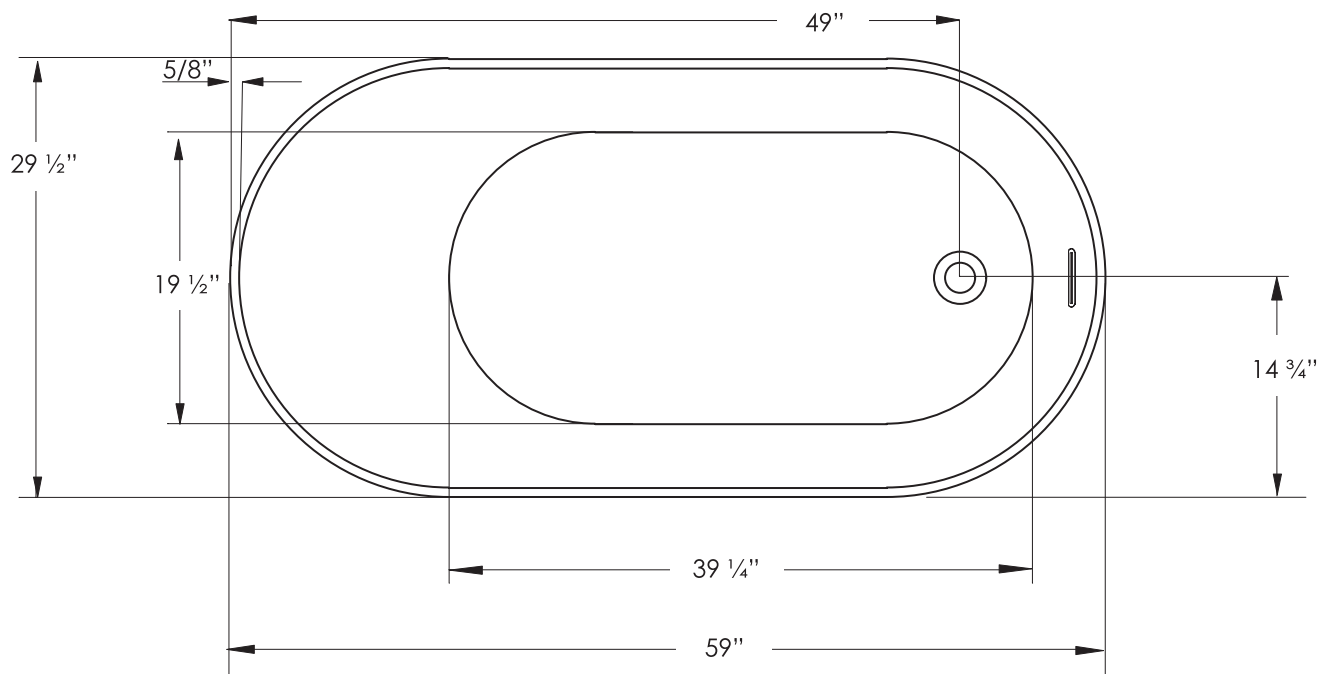

**INSTALLATION: Measure tub before installing.**

Dimensional variance on drawings may be +/- 1/2 inch and are subject to change without notice.

© 2023 Jetta Corporation. All rights reserved. Specifications are subject to change without notice. REV 4/23



JETTACORP.COM